

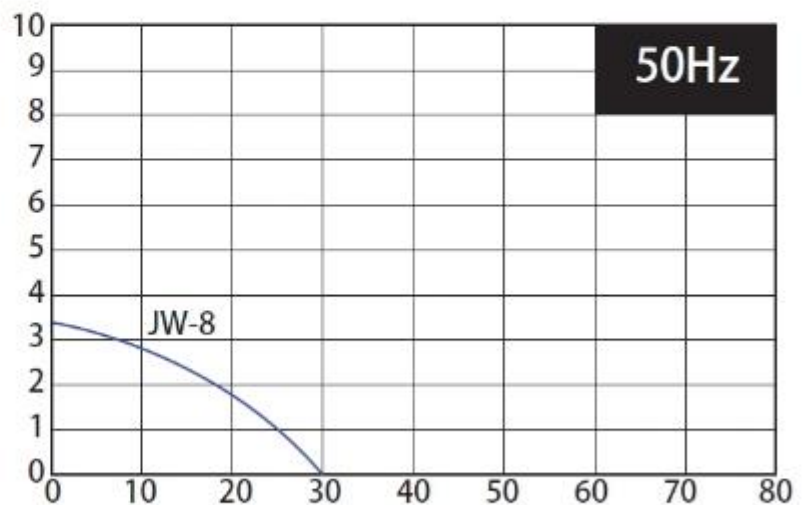

JW-8 Series

Motor Casing	Cast iron
Pump Casing	Cast iron
Shaft	Carbon steel
Impeller	Polyoxymethylene / Aluminum alloy
Pump Cap	Polyoxymethylene / Cast iron

*Photo shows jw8-180

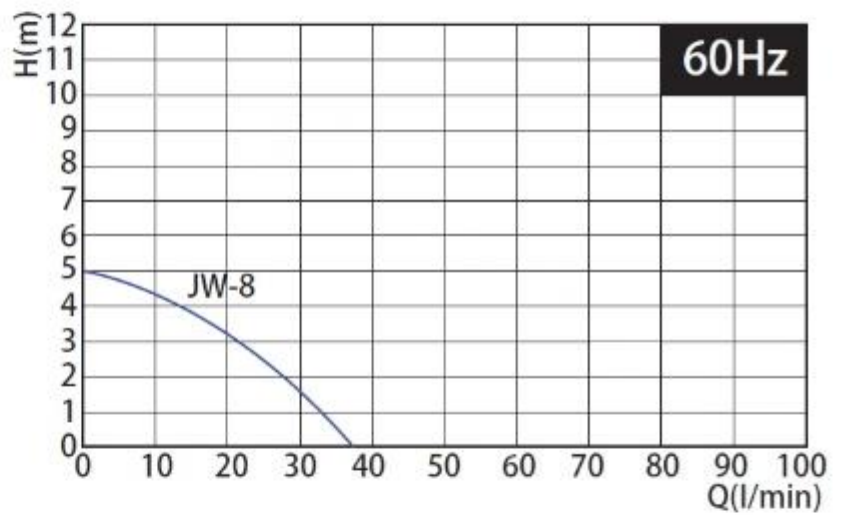
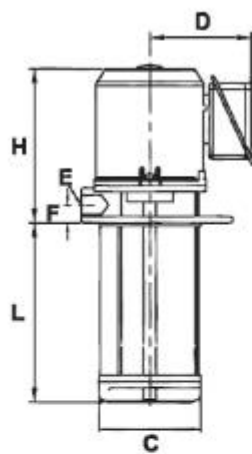
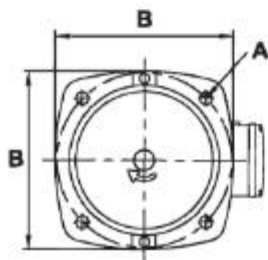

Products Data Sheet :

Type	Power	A	B	C	D	E	F	H	L	Weight
	HP / KW	mm	mm	mm	mm	PT	mm	mm	mm	Kg
JW-8100	1/8HP / 0.093KW	4XØ8 PCD128	155	92	105	3/8"/ 1/2"	19	160	100	5.8
JW-8120	1/8HP / 0.093KW	4XØ8 PCD128	155	92	105	3/8"/ 1/2"	19	160	120	5.9
JW-8150	1/8HP / 0.093KW	4XØ8 PCD128	155	92	105	3/8"/ 1/2"	19	160	150	6.0
JW-8180	1/8HP / 0.093KW	4XØ8 PCD128	155	92	105	3/8"/ 1/2"	19	160	180	6.1
JW-8220	1/8HP / 0.093KW	4XØ8 PCD128	155	92	105	3/8"/ 1/2"	19	160	220	6.9

Application :

Immersion Type Centrifugal Pumps function to dissipate the heat from cutting edges and work piece. Our pumps could be found using in various machines like Drilling, Grinding, Turning, Milling, Cutting, Slitting and many others.

Pump Construction :

The pump is one-chamber vertical centrifugal pump, co-axial pump/motor design, impellers mounted on extended motor shaft.

Motor :

Frequency range : 50/60 Hz

Nominal speed : 2850/3450

Pole : 2P

Standard voltages :

1Ø 50/60Hz : 100-120V/200-240V

3Ø 50Hz : 200-255V/380-440V

3Ø 60Hz : 200-255V/380-480V

3Ø 60Hz : 575V

Protection class : IP54

Insulation class : F

Operation Conditions :

Ambient temperature : 0°C~+50°C

Liquid temperature range : 0°C~+90°C

Operating pressure : Max. 10 kg/cm²